

VISTA 1

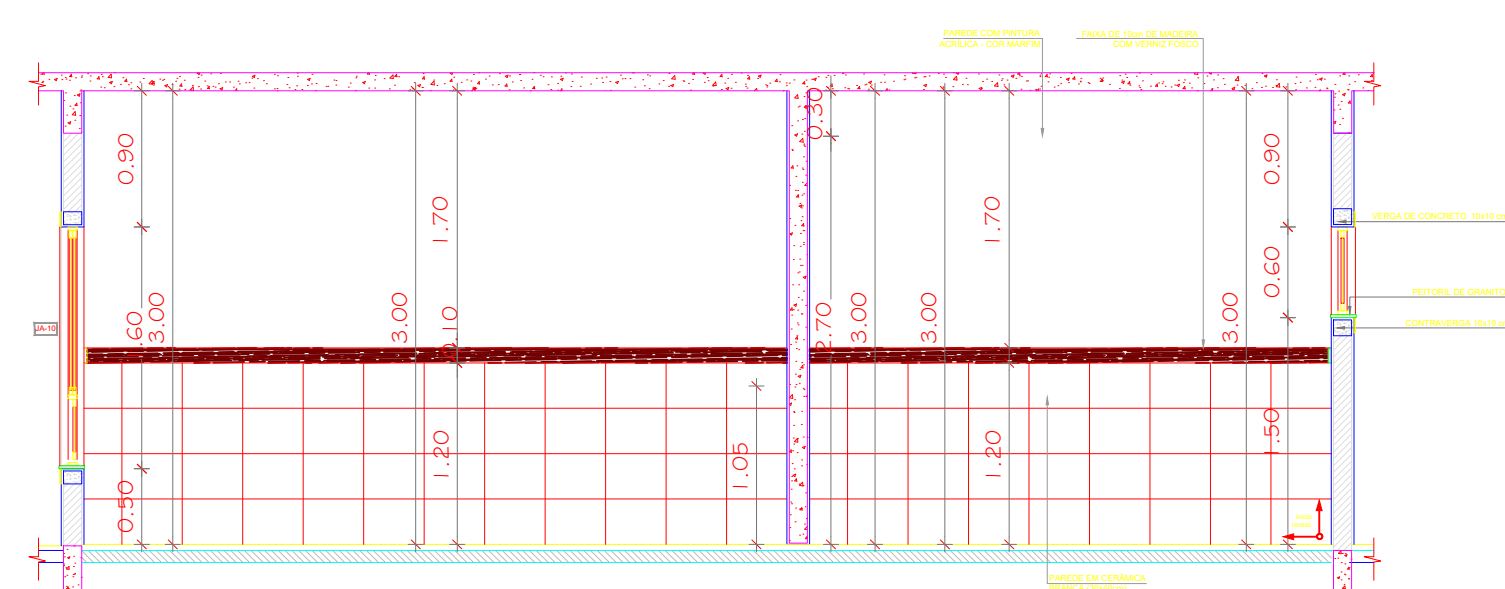

VISTA 3

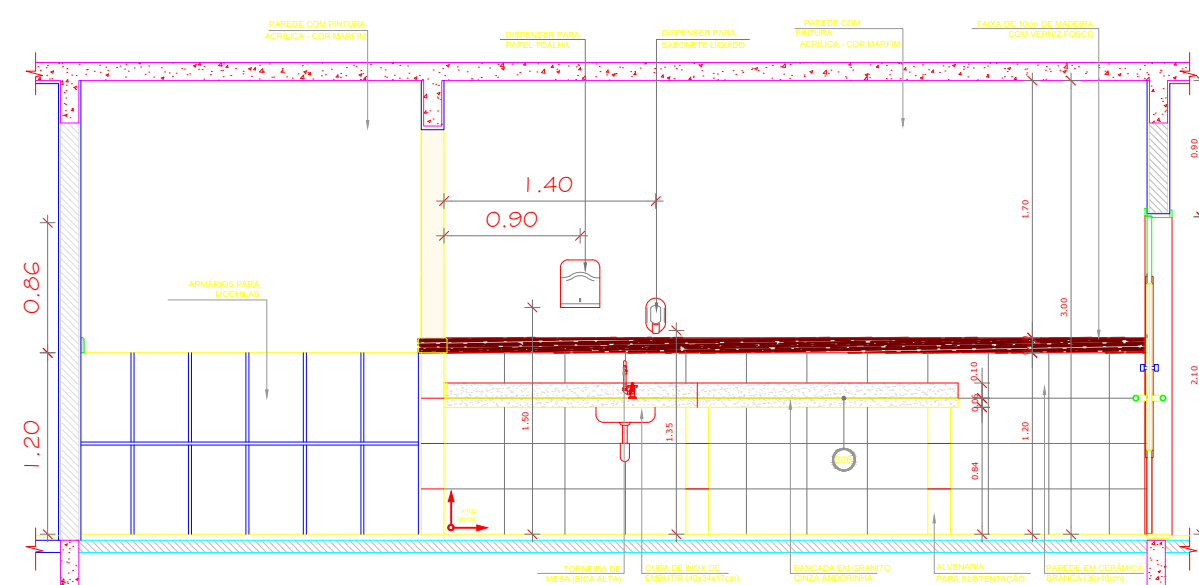

VISTA 2

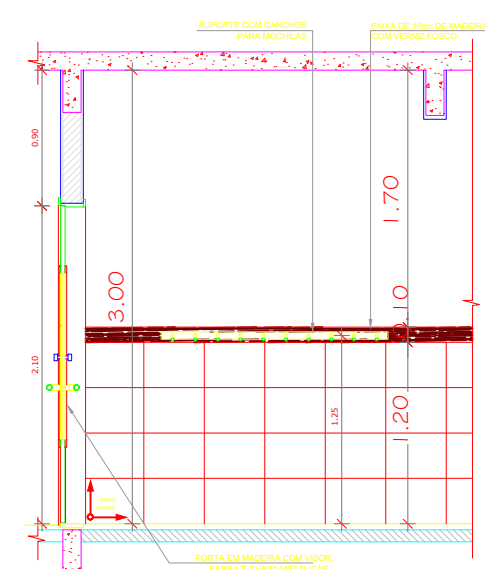
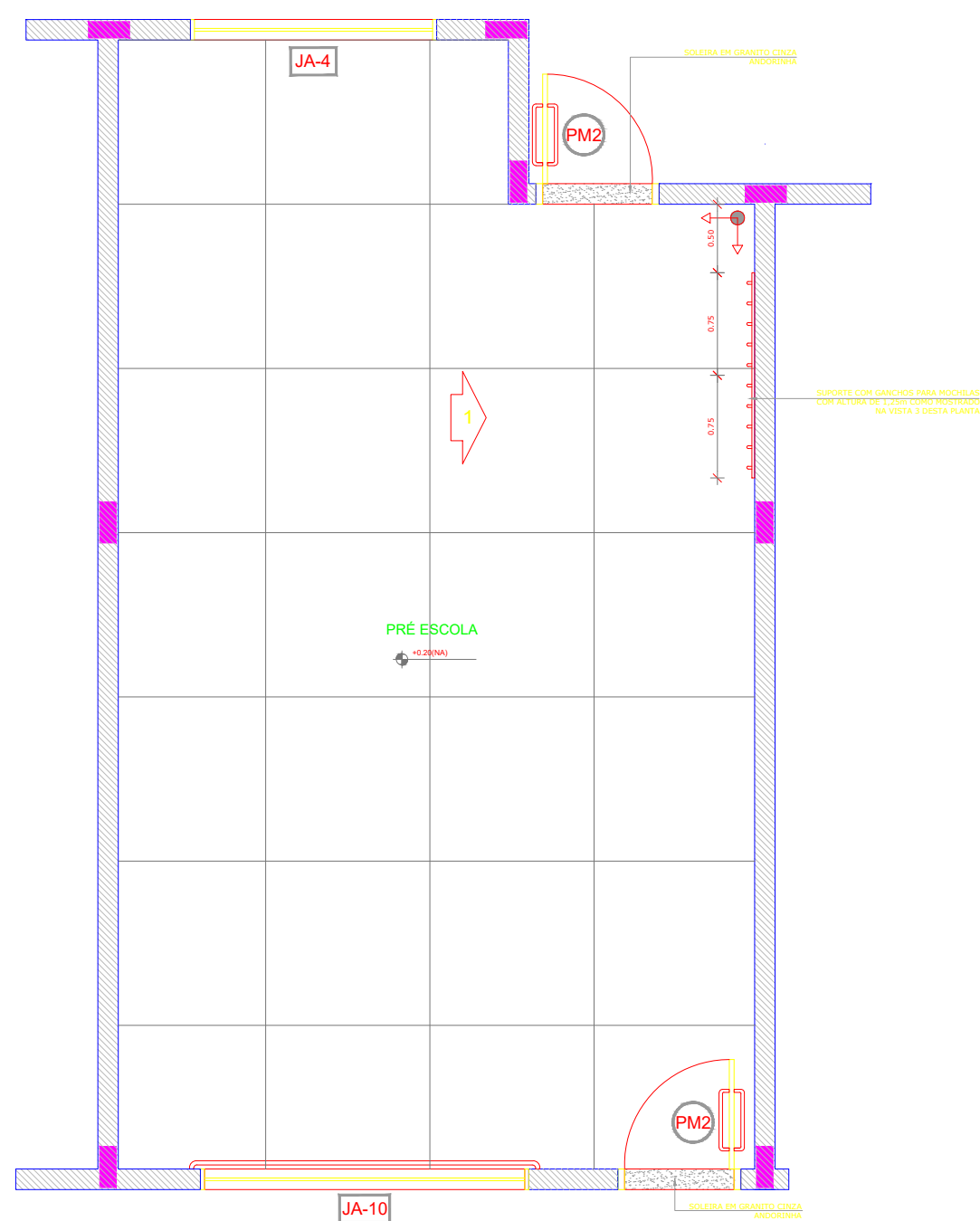
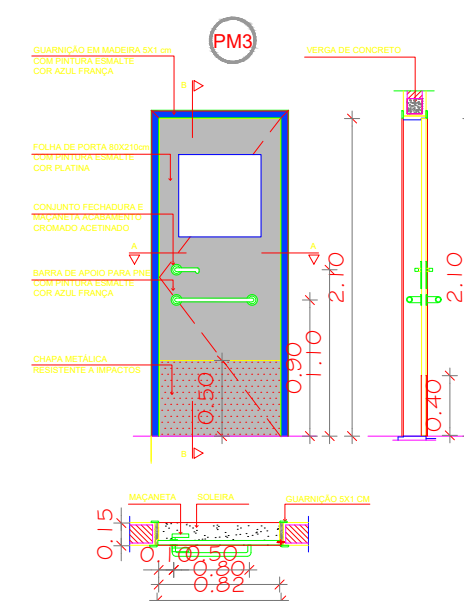
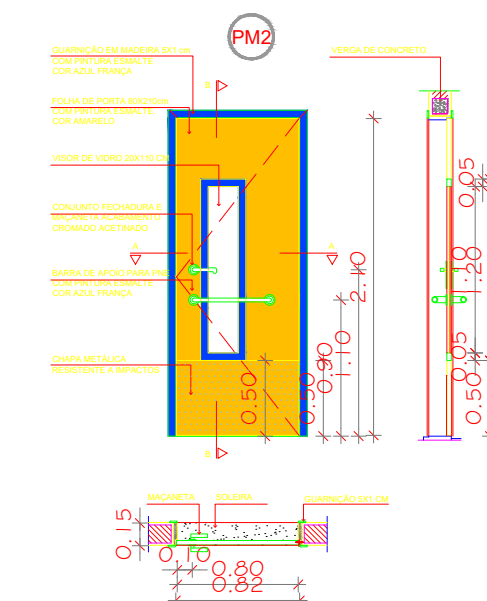
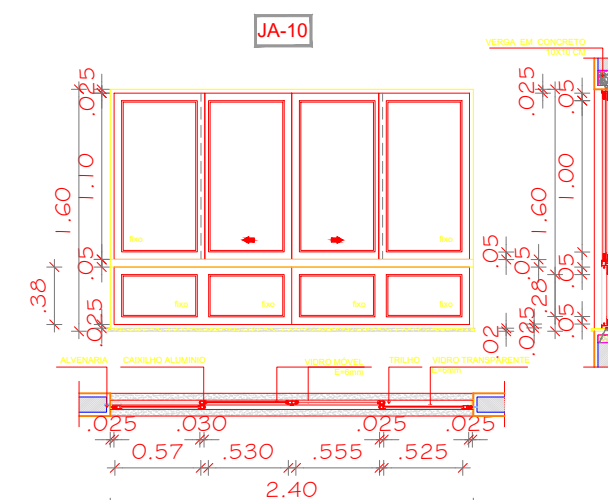
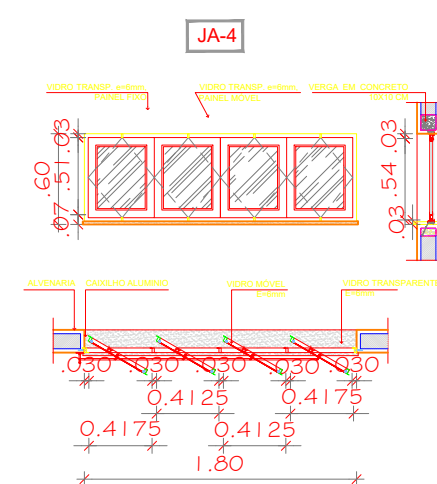
PRÉ ESCOLA
VISTA 1

DETALHE 01

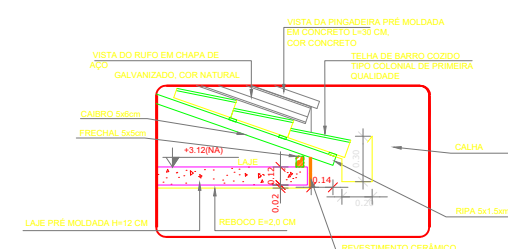

DETALHE 02

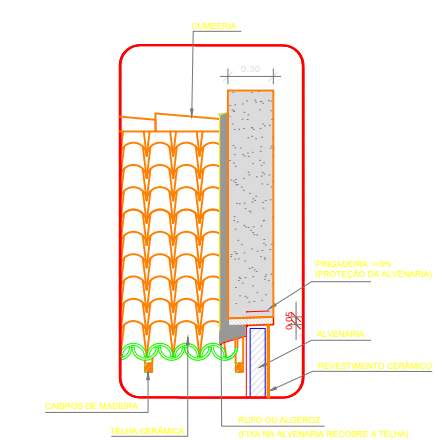

DETALHE 03

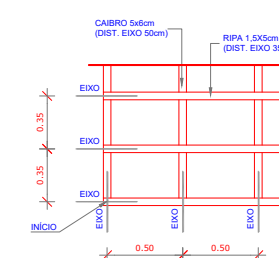

abril/2026	PROJETO ARQUITETÔNICO	Folha: 01/05
Planta baixa - Cortes		
Proprietário: PREF. MUNICIPAL DE CONC. DO RIO VERDE Endereço: RUA BELZONY PAGANELLI CARNEIRO, 1750 Bairro Nazaré - CONCEIÇÃO DO RIO VERDE - MG		
<div style="text-align: center; padding-top: 50px;">Cortes e Detalhes</div>	<div style="border-top: 1px solid black; padding-top: 10px;"> Declaro que a aprovação do projeto não implica no reconhecimento do direito de propriedade por parte da prefeitura. </div> <div style="border-top: 1px solid black; padding-top: 20px;"> PROPRIETÁRIO PREF. MUNICIPAL DE CONC. DO RIO VERDE CNFJ: 18.008.888/000174 </div>	
<div style="text-align: center; padding-top: 20px;"> ÁREAS: A CONSTRUIR:.....230,00m² TERRENO:.....2.640,00m² </div>	<div style="border-top: 1px solid black; padding-top: 10px;"> R.T. Engenheiro Civil José Russano Neto CREA-MG 428470MG </div>	
VISTOS:		